

**EXPLANATION**

--- PARCEL BOUNDARY

■ PROPERTY TRANSFERABLE UNDER CERCLA 120 (H)(3)



0 50 100  
SCALE IN FEET

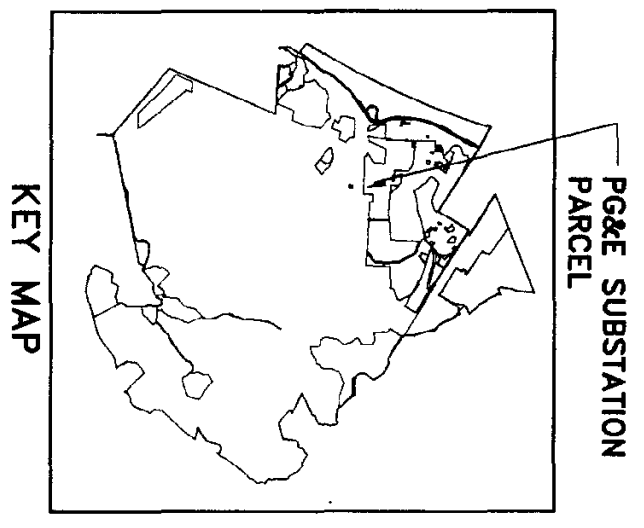
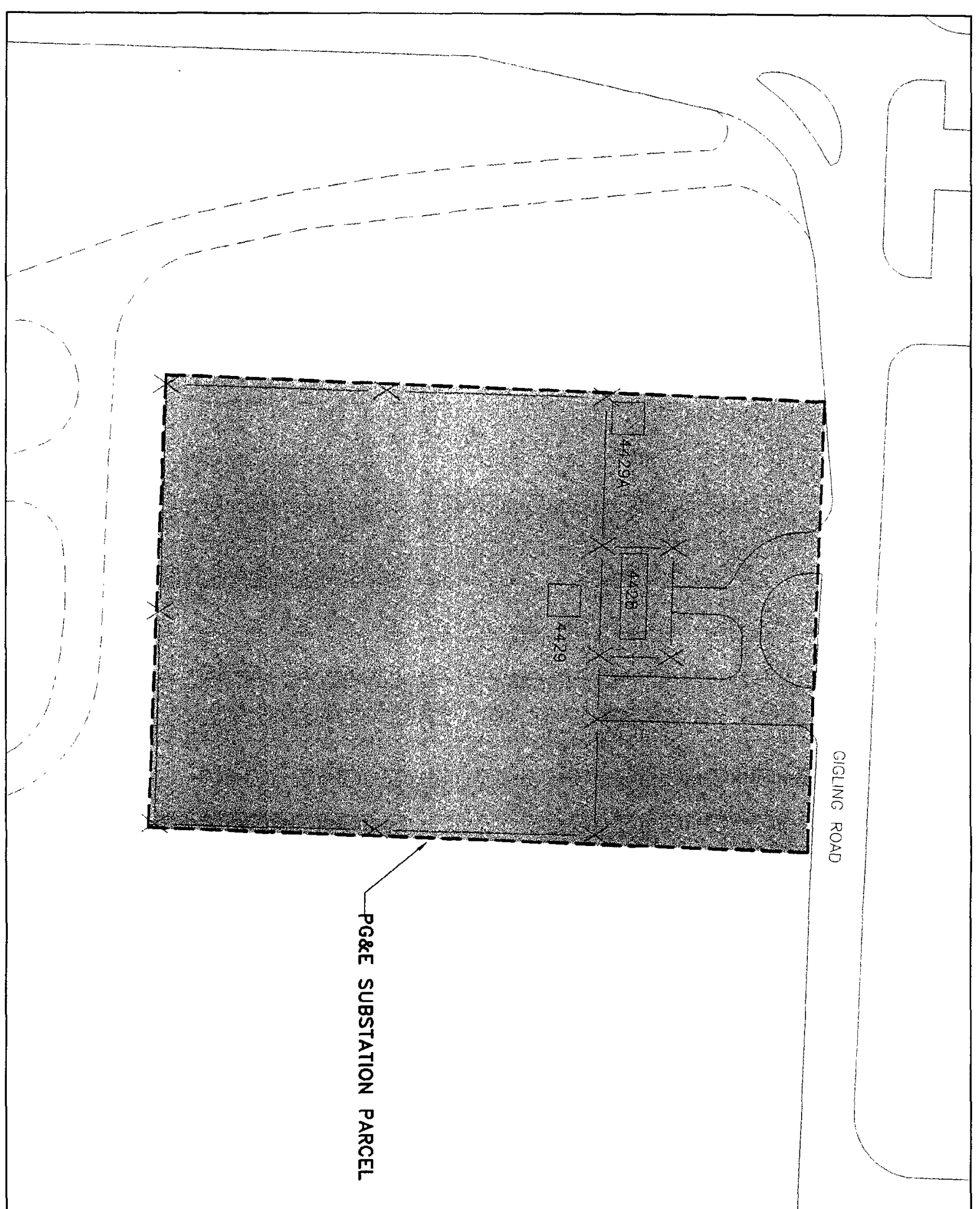

PROPERTY BOUNDARIES INDICATED ARE APPROXIMATE AND ARE NOT INTENDED TO REPRESENT THE LEGAL DESCRIPTION OF THE PARCEL(S).

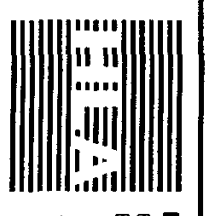

**Harding Lawson Associates**  
Engineering and  
Environmental Services

DRAWN RJP JOB NUMBER 25894 0017715

APPROVED *[Signature]*  
Property Transferable Under CERCLA  
PG&E Substation Parcel  
Environmental Baseline Survey  
Former Fort Ord, California

DATE 6/95

REVISID DATE