

PROPERTY BOUNDARIES INDICATED ARE APPROXIMATE AND ARE NOT INTENDED TO REPRESENT THE LEGAL DESCRIPTION OF THE PARCEL(S).

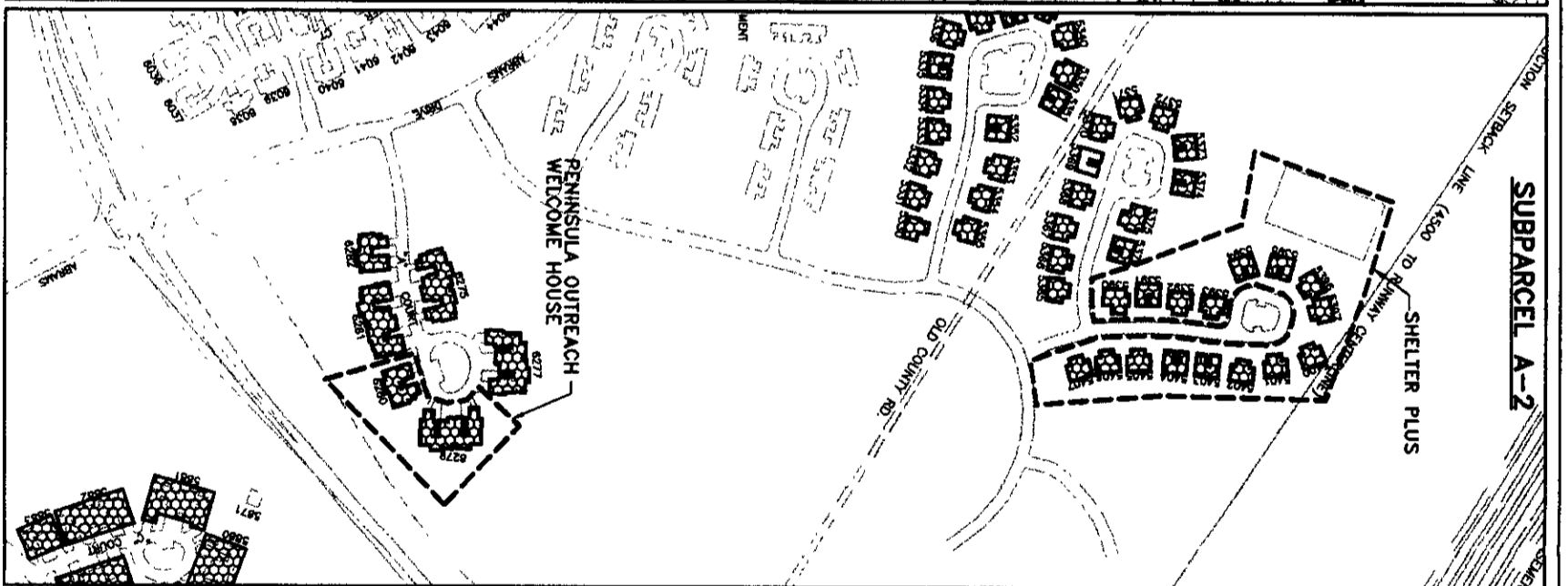
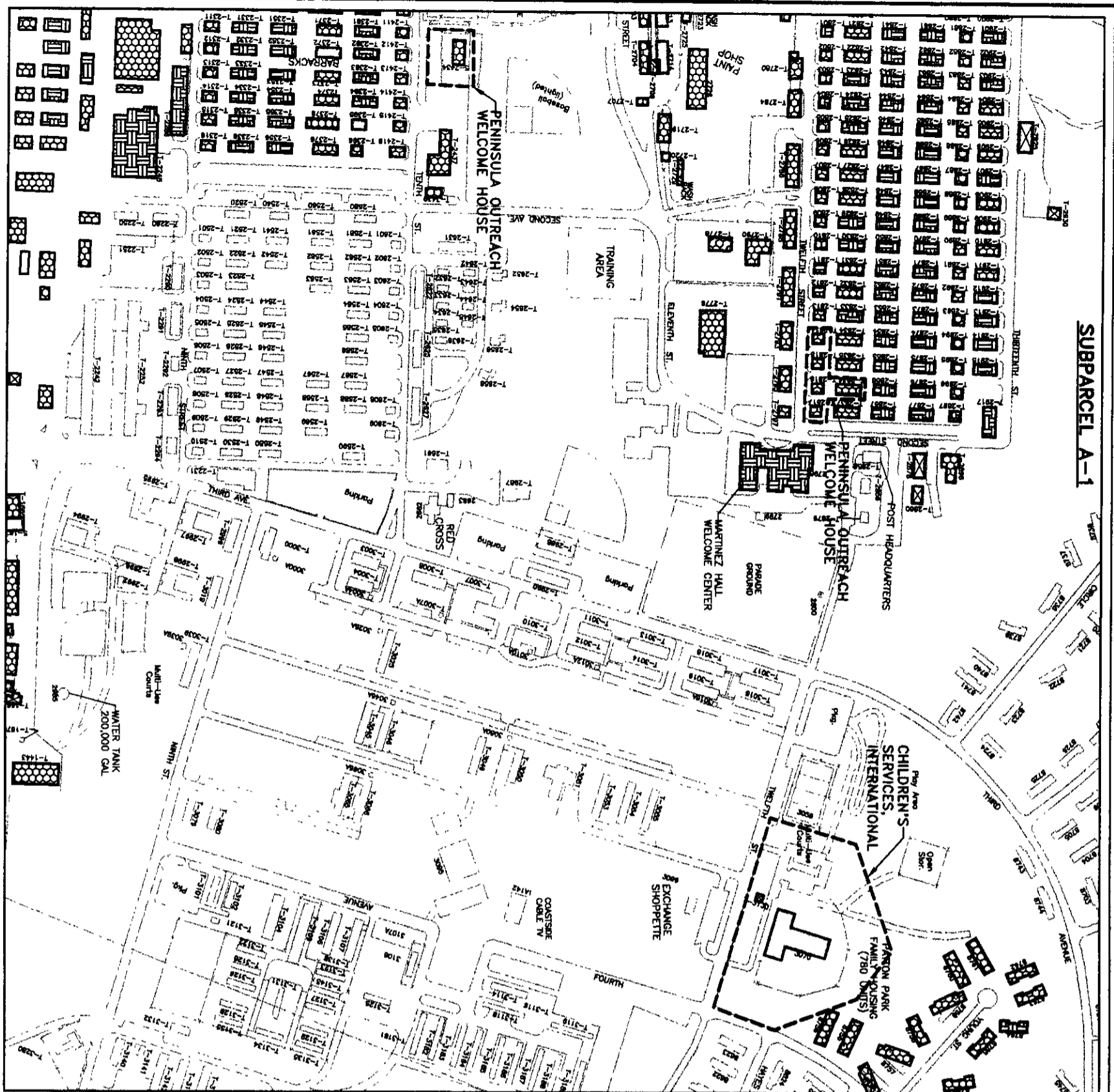
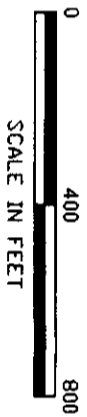

EXPLANATION

--- PARCEL BOUNDARY

ASBESTOS-CONTAINING MATERIALS (ACM)

□ IDENTIFIES BUILDINGS IN WHICH NO ACM WERE FOUND (RATING 0)

▣ IDENTIFIES BUILDINGS IN WHICH ACM RATED 1 TO 5 (OF IMMEDIATE CONCERN) WERE FOUND

▤ IDENTIFIES BUILDINGS IN WHICH ACM RATED 6 TO 13 WERE FOUND OR ARE SUSPECTED TO CONTAIN ACM RATED 6 TO 13 BASED ON SURVEYS OF OTHER REPRESENTATIVE BUILDINGS

☒ IDENTIFIES STRUCTURES FOR WHICH NO SURVEY DATA ARE PRESENTED, BECAUSE EITHER (a) THEY NO LONGER EXIST OR (b) THEY ARE NOT BUILDINGS AND WERE NOT SURVEYED (i.e., FLAGPOLES, LOADING DOCKS, ETC.) OR (c) NO CONSTRUCTION DATES WERE AVAILABLE.

NOTE: THERE MAY BE BUILDINGS THAT WERE IDENTIFIED DURING THE ASBESTOS SURVEYS BUT WERE NOT PART OF THIS BASE MAP AND ARE, THEREFORE, NOT ON THIS PLATE. THESE BUILDINGS OR STRUCTURES ARE IDENTIFIED IN APPENDIX C. INFORMATION FOR SOME BUILDINGS MAY NOT BE AVAILABLE.

KEY MAP

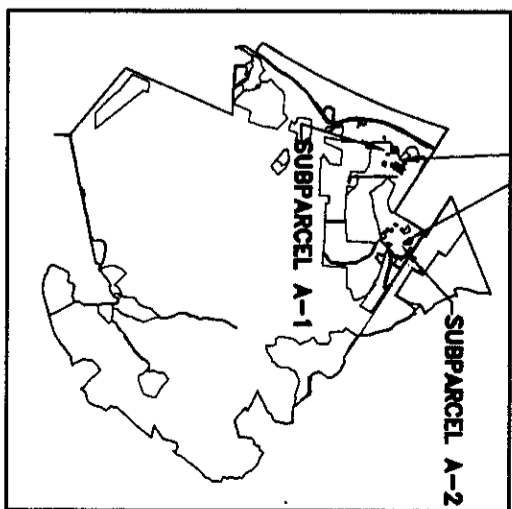

**McKINNEY HOMELESS ACT
GROUP A PARCELS**

Harding Lawson Associates

Engineering and
Environmental Services

DRAWN RJP JOB NUMBER 25894 0017614

Asbestos Investigations in Buildings

McKinney Homeless Act
Group A Parcels
Environmental Baseline Survey
Former Fort Ord, California

APPROVED SR DATE 5/95

PLATE

4

REVISED DATE