

PROPERTY BOUNDARIES INDICATED ARE APPROXIMATE AND ARE NOT INTENDED TO REPRESENT THE LEGAL DESCRIPTION OF THE PARCEL(S).

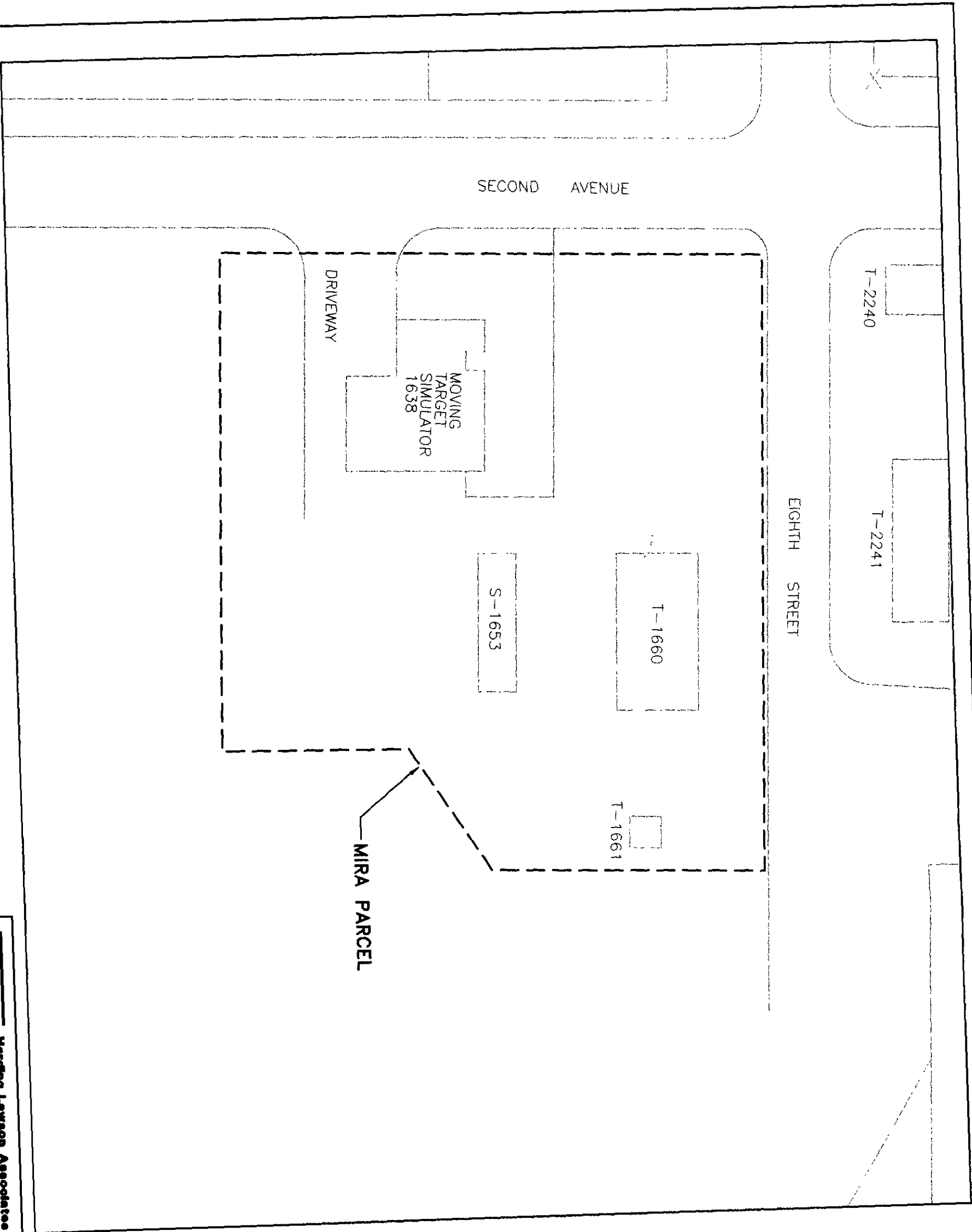

EXPLANATION

--- PARCEL BOUNDARY

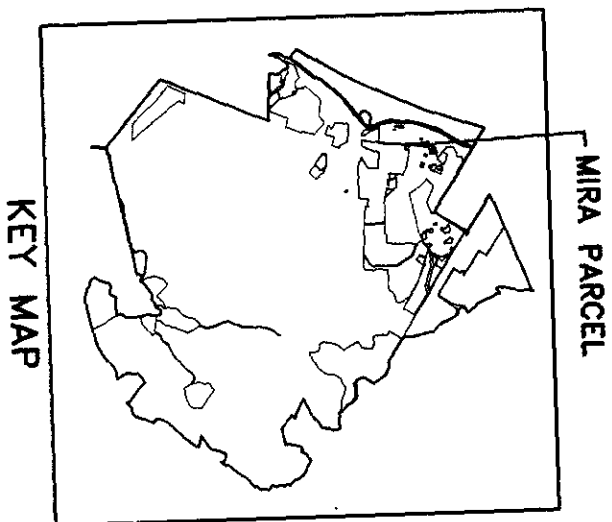
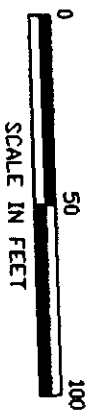

KEY MAP

MIRA PARCEL

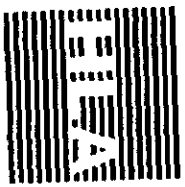

Harding Lawson Associates
Engineering and
Environmental Services

DRAWN RJP
JOB NUMBER 25894 0017713

Parcel Map
Monterey Institute for Research
in Astronomy (MIRA) Parcel
Environmental Baseline Survey
Former Fort Ord, California

APPROVED [Signature]
DATE 1/95

REVISED DATE 3/22/95