

**LEGEND**

- SOIL VAPOR EXTRACTION WELL
- DEEP (80-85 FT.) MONITORING PROBE
- TEMPORARY SOIL GAS MONITORING PROBE SAMPLED MARCH TO JUNE 2003
- 280 ppbv - 78' CARBON TETRACHLORIDE CONCENTRATION MARCH-JUNE 2003; DEPTH OF PROBE SHOWN
- 210 ppbv CARBON TETRACHLORIDE CONCENTRATION - MARCH 2004
- 38 ppbv CARBON TETRACHLORIDE CONCENTRATION - APRIL 2004
- 14 ppbv CARBON TETRACHLORIDE CONCENTRATION - MAY 2004
- 14 ppbv CARBON TETRACHLORIDE CONCENTRATION - JUNE-AUGUST 2004
- 5.6 ppbv CARBON TETRACHLORIDE CONCENTRATION - SEPTEMBER 2004
- 6.7 ppbv CARBON TETRACHLORIDE CONCENTRATION - OCTOBER 2004
- 2.6 ppbv CARBON TETRACHLORIDE CONCENTRATION - NOVEMBER 2004
- 2.3 ppbv CARBON TETRACHLORIDE CONCENTRATION - MAY 2005
- CARBON TETRACHLORIDE CONCENTRATION CONTOURS AT 85 FT. DEPTH (ppbv) PRIOR TO SVE OPERATION; DASHED WHERE INFERRED
- BUILDING

**NOTES:**

1. March Carbon Tetrachloride concentrations measured between 3/29/04 and 4/1/04, before SVE operation.
2. April Carbon Tetrachloride concentrations measured 4/28/04.
3. May 2004 Carbon Tetrachloride concentrations measured 5/18/04.
4. June-August Carbon Tetrachloride concentrations measured 6/14, 6/17, 7/2, 7/20, and 8/4/04.
5. September Carbon Tetrachloride concentrations measured 9/2/04 and 9/23/04.
6. October Carbon Tetrachloride concentrations measured 10/7/04, 10/14/04, and 10/22/04.
7. November Carbon Tetrachloride concentrations measured 11/17/04, 11/18/04, and 11/22/04.
8. May 2005 Carbon Tetrachloride concentrations measured 5/24/05 and 5/25/05.
9. J is a laboratory qualifier (estimated value).
10. Phase I SVE operation April 6 to June 14, 2004; Phase II Sept. 9 to Nov 8, 2004.

C	8/15/05	CT SVE REPORT	ES	PK
REVISION	DATE	DESCRIPTION	CHKD	APPR
Shaw Environmental, Inc.		Department of the Army Sacramento District, Corps of Engineers Sacramento, California		
DESIGNED:	<b>FIGURE 5-5</b> <b>CARBON TETRACHLORIDE CONCENTRATIONS</b> <b>DEEP MONITORING PROBES</b> <b>OPERABLE UNIT CARBON TETRACHLORIDE</b> <b>FORMER FORT ORD, CALIFORNIA</b>			
DRAWN:				
CHECKED:				
SUBMITTED:	DATE	SCALE:	SPEC. No.	
		SHEET	FILE No. CTdeep_May2005.mxd	

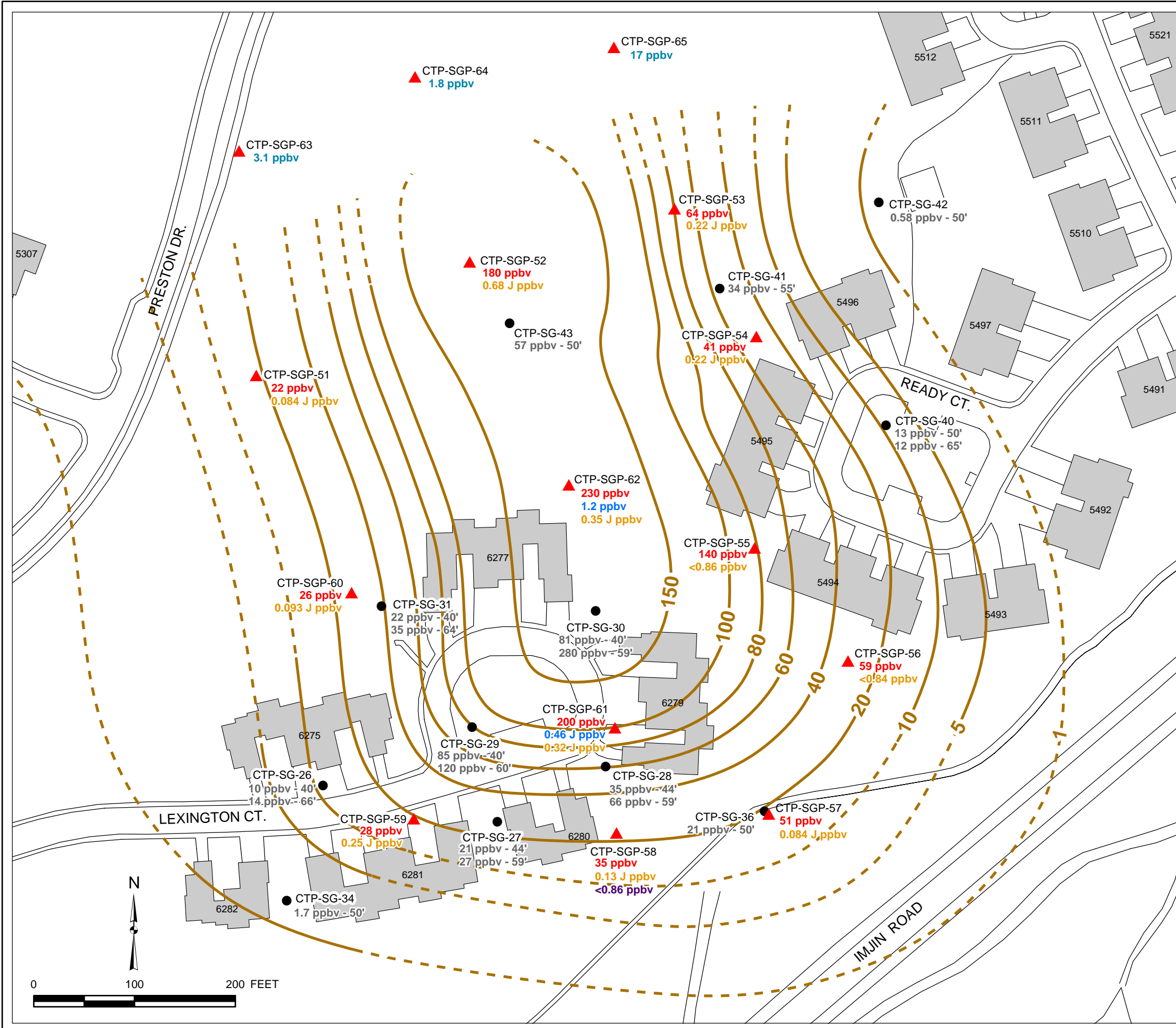

**LEGEND**

- ▲ INTERMEDIATE (55-60 FT.) MONITORING PROBE
- TEMPORARY SOIL GAS MONITORING PROBE SAMPLED MARCH TO JUNE 2003
- 230 ppbv CARBON TETRACHLORIDE CONCENTRATION MARCH-JUNE 2003; PROBE DEPTH SHOWN
- 1.2 ppbv CARBON TETRACHLORIDE CONCENTRATION - MARCH 2004
- 1.2 ppbv CARBON TETRACHLORIDE CONCENTRATION - APRIL 2004
- 1.2 ppbv CARBON TETRACHLORIDE CONCENTRATION - JUNE 2004
- 3.1 ppbv CARBON TETRACHLORIDE CONCENTRATION - SEPTEMBER 2004
- <0.86 ppbv CARBON TETRACHLORIDE CONCENTRATION - NOVEMBER 2004
- CARBON TETRACHLORIDE CONCENTRATION CONTOURS AT 60 FT. DEPTH (ppbv) PRIOR TO SVE OPERATION; DASHED WHERE INFERRED
- BUILDING

**NOTES:**

1. March Carbon Tetrachloride concentrations measured between 3/29/04 and 3/31/04, before SVE operation.
2. April Carbon Tetrachloride concentrations measured 4/28/04.
3. June Carbon Tetrachloride concentrations measured between 6/15/04 and 6/17/04.
4. September Carbon Tetrachloride concentrations measured 9/1/04 and 9/2/04.
5. November Carbon Tetrachloride concentrations measured 11/18/04.
6. J is a laboratory qualifier (estimated value).
7. SVE operation started April, 6, 2004.
8. Phase I SVE operation April 6 to June 14, 2004; Phase II Sept. 9 to Nov. 8, 2004.

C	8/15/05	CT SVE REPORT	ES	PK
REVISION	DATE	DESCRIPTION	CHKD	APPR
		Department of the Army Sacramento District, Corps of Engineers Sacramento, California		
DESIGNED:	<b>FIGURE 5-6</b> <b>CARBON TETRACHLORIDE CONCENTRATIONS</b> <b>INTERMEDIATE MONITORING PROBES</b> <b>OPERABLE UNIT CARBON TETRACHLORIDE</b> <b>FORMER FORT ORD, CALIFORNIA</b>			
DRAWN:				
CHECKED:				
SUBMITTED:	DATE	SCALE:	SPEC. No.	
		SHEET	FILE No.	
			CTinter_Nov2004.mxd	