

LEGEND

- ▲ SHALLOW (25-30 FT.) MONITORING PROBE
- TEMPORARY SOIL GAS MONITORING PROBE SAMPLED MARCH TO JUNE 2003
- 18 ppbv - 30' CARBON TETRACHLORIDE CONCENTRATION MARCH-JUNE 2003; PROBE DEPTH SHOWN
- 26 ppbv CARBON TETRACHLORIDE CONCENTRATION - MARCH 2004
- 11 ppbv CARBON TETRACHLORIDE CONCENTRATION - APRIL 2004
- <0.80 ppbv CARBON TETRACHLORIDE CONCENTRATION - MAY 2004
- 0.12 J ppbv CARBON TETRACHLORIDE CONCENTRATION - JUNE 2004
- 2.9 ppbv CARBON TETRACHLORIDE CONCENTRATION - SEPTEMBER 2004
- 1.0 ppbv CARBON TETRACHLORIDE CONCENTRATION - NOVEMBER 2004
- 1.0 ppbv CARBON TETRACHLORIDE CONCENTRATION - MAY 2005
- BUILDING

- NOTES:
1. March Carbon Tetrachloride concentrations measured between 3/25/04 and 3/31/04, before SVE operation.
 2. April Carbon Tetrachloride concentrations measured 4/28/04.
 3. May Carbon Tetrachloride concentrations measured 5/18/04 and 5/19/04.
 4. June Carbon Tetrachloride concentrations measured between 6/15/04 and 6/17/04.
 5. September Carbon Tetrachloride concentrations measured 9/1/04 and 9/2/04.
 6. November Carbon Tetrachloride concentrations measured 11/17/04, 11/18/04 and 11/22/04.
 7. May 2005 Carbon Tetrachloride concentrations measured 5/24/05 and 5/25/05.
 8. J is a laboratory qualifier (estimated value).
 9. Phase I SVE operation April 6 to June 14, 2004; Phase II Sept. 9 to Nov 8, 2004.

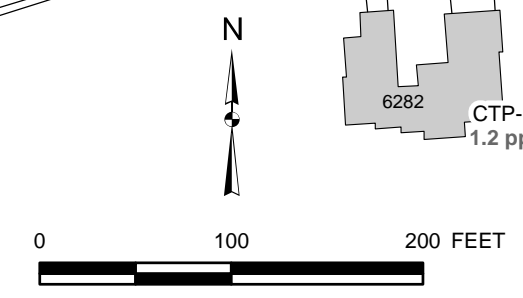

C	8/15/05	CT SVE REPORT	ES	PK
REVISION	DATE	DESCRIPTION	CHKD	APPR
		Department of the Army Sacramento District, Corps of Engineers Sacramento, California		
DESIGNED:	FIGURE 5-7 CARBON TETRACHLORIDE CONCENTRATIONS SHALLOW MONITORING PROBES OPERABLE UNIT CARBON TETRACHLORIDE FORMER FORT ORD, CALIFORNIA			
DRAWN:				
CHECKED:				
SUBMITTED:	DATE	SCALE:	SPEC. No.	
		SHEET	FILE No.	
			CTshallow_May2005.mxd	

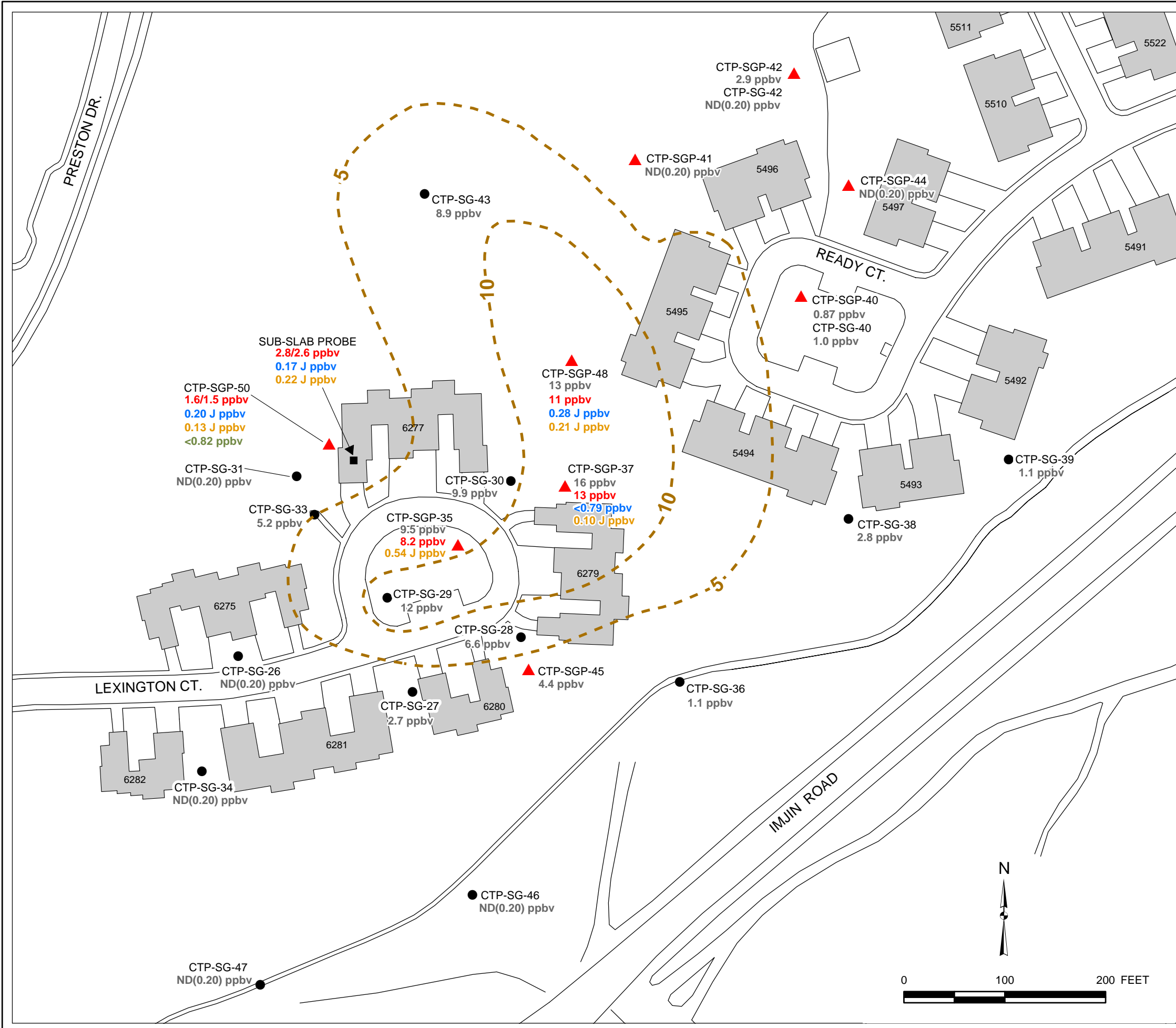

LEGEND

- ▲ NEAR SURFACE (6 FT.) MONITORING PROBE
- TEMPORARY SOIL GAS MONITORING PROBE SAMPLED MARCH TO JUNE 2003
- 13 ppbv CARBON TETRACHLORIDE CONCENTRATION - MARCH-JUNE 2003
- 11 ppbv CARBON TETRACHLORIDE CONCENTRATION - MARCH 2004
- 0.28 J ppbv CARBON TETRACHLORIDE CONCENTRATION - APRIL 2004
- 0.21 J ppbv CARBON TETRACHLORIDE CONCENTRATION - JUNE 2004
- <0.82 ppbv CARBON TETRACHLORIDE CONCENTRATION - MAY 2005
- - - CARBON TETRACHLORIDE CONCENTRATION CONTOURS AT 6 FT. DEPTH (ppbv); PRIOR TO SVE OPERATION
- BUILDING

NOTES:

1. March Carbon Tetrachloride concentrations measured between 3/25/04 and 3/31/04, except CTP-SGP-50 and Sub-Slab Probe measured 3/9/04 and 3/15/04, before SVE operation.
2. April Carbon Tetrachloride concentrations measured 4/28/04.
3. June Carbon Tetrachloride concentrations measured 6/18/04.
4. May 2005 Carbon Tetrachloride concentrations measured 5/25/05.
5. Carbon Tetrachloride concentration contours provided by Mactec and based on data collected March to July 2003; adjusted for March 2004 data.
6. J is a laboratory qualifier (estimated value).
7. Phase I SVE operation April 6 to June 14, 2004; Phase II Sept. 9 to Nov. 8, 2004.

C	8/15/05	CT SVE REPORT	ES	PK
REVISION	DATE	DESCRIPTION	CHKD	APPR
		Department of the Army Sacramento District, Corps of Engineers Sacramento, California		
DESIGNED: E. SCHMIDT	FIGURE 5-8 CARBON TETRACHLORIDE CONCENTRATIONS NEAR-SURFACE MONITORING PROBES OPERABLE UNIT CARBON TETRACHLORIDE FORMER FORT ORD, CALIFORNIA			
DRAWN: K. BLACK				
CHECKED: P. KELSALL				
SUBMITTED:	DATE	SCALE:	FILE No.	SPEC. No.
		SHEET	CTsurface_May2005.mxd	

