

LEGEND

- SOIL VAPOR EXTRACTION WELL
- DEEP (80-85 FT.) MONITORING PROBE
- TEMPORARY SOIL GAS MONITORING PROBE SAMPLED MARCH TO JUNE 2003
- 14 ppbv** CHLOROFORM CONCENTRATION MARCH-JUNE 2003; DEPTH OF PROBE SHOWN
- 3.8 ppbv (0.05)** CHLOROFORM CONCENTRATION MARCH 2004 (CHLOROFORM / CARBON TETRACHLORIDE RATIO)
- 4.2 ppbv (0.28)** CHLOROFORM CONCENTRATION APRIL 2004 (CHLOROFORM / CARBON TETRACHLORIDE RATIO)
- 3.6 ppbv (0.13)** CHLOROFORM CONCENTRATION MAY 2004 (CHLOROFORM / CARBON TETRACHLORIDE RATIO)
- 2.1 ppbv (0.21)** CHLOROFORM CONCENTRATION JUNE-AUGUST 2004 (CHLOROFORM / CARBON TETRACHLORIDE RATIO)
- 2 ppbv (0.22)** CHLOROFORM CONCENTRATION SEPTEMBER 2004 (CHLOROFORM / CARBON TETRACHLORIDE RATIO)
- 2.8 ppbv (0.30)** CHLOROFORM CONCENTRATION OCTOBER 2004 (CHLOROFORM / CARBON TETRACHLORIDE RATIO)
- 1.3 ppbv (0.06)** CHLOROFORM CONCENTRATION NOVEMBER 2004 (CHLOROFORM / CARBON TETRACHLORIDE RATIO)
- 1.1 ppbv (3.5)** CHLOROFORM CONCENTRATION MAY 2005 (CHLOROFORM / CARBON TETRACHLORIDE RATIO)
- CARBON TETRACHLORIDE CONCENTRATION CONTOURS AT 85 FT. DEPTH (ppbv) PRIOR TO SVE OPERATION; DASHED WHERE INFERRED
- BUILDING

NOTES:

1. March Chloroform concentrations measured between 3/29/04 and 4/1/04, before SVE operation.
2. April Chloroform concentrations measured 4/28/04.
3. May 2004 Chloroform concentrations measured 5/18/04.
4. June-August Chloroform concentrations measured 6/14, 6/17, 7/2, 7/20, and 8/4/04.
5. September Chloroform concentrations measured 9/2/04 and 9/23/04.
6. October Chloroform concentrations measured 10/6/04 and 10/7/04.
7. November Chloroform concentrations measured 11/17/04, 11/18/04, and 11/22/04.
8. May 2005 Chloroform concentrations measured 5/24/05 and 5/25/05.
9. J is a laboratory qualifier (estimated value).
10. Phase I SVE operation April 6 to June 14, 2004; Phase II Sept. 9 to Nov. 8, 2004.

C	8/15/05	CT SVE REPORT	ES	PK
REVISION	DATE	DESCRIPTION	CHKD	APPR
Shaw Environmental, Inc.		Department of the Army Sacramento District, Corps of Engineers Sacramento, California		
DESIGNED:	FIGURE 5-9 CHLOROFORM CONCENTRATIONS DEEP MONITORING PROBES OPERABLE UNIT CARBON TETRACHLORIDE FORMER FORT ORD, CALIFORNIA			
DRAWN:				
CHECKED:				
SUBMITTED:	DATE	SCALE:	SPEC. No.	
		SHEET	FILE No. CTdeep_CF.mxd	

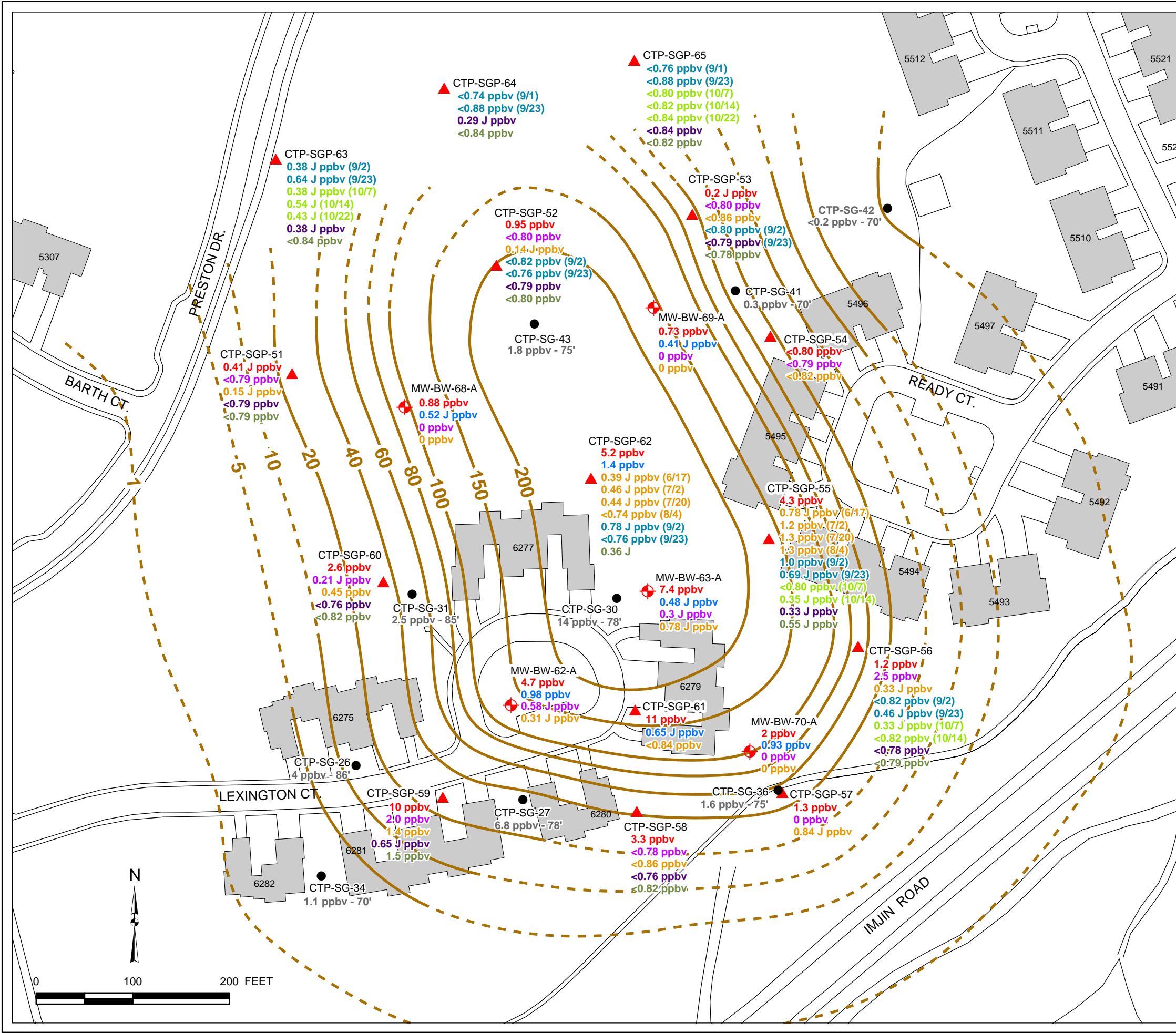

LEGEND

- SOIL VAPOR EXTRACTION WELL
- DEEP (80-85 FT.) MONITORING PROBE
- TEMPORARY SOIL GAS MONITORING PROBE SAMPLED MARCH TO JUNE 2003
- 14 ppbv** TRICHLOROETHENE CONCENTRATION MARCH-JUNE 2003; DEPTH OF PROBE SHOWN
- 1.2 ppbv** TRICHLOROETHENE CONCENTRATION - MARCH 2004
- 0.48 ppbv** TRICHLOROETHENE CONCENTRATION - APRIL 2004
- 2.5 ppbv** TRICHLOROETHENE CONCENTRATION - MAY 2004
- 0.33 ppbv** TRICHLOROETHENE CONCENTRATION - JUNE-AUGUST 2004
- 0.46 ppbv** TRICHLOROETHENE CONCENTRATION - SEPTEMBER 2004
- 0.33 ppbv** TRICHLOROETHENE CONCENTRATION - OCTOBER 2004
- 0.33 ppbv** TRICHLOROETHENE CONCENTRATION - NOVEMBER 2004
- 1.5 ppbv** TRICHLOROETHENE CONCENTRATION - MAY 2005
- CARBON TETRACHLORIDE CONCENTRATION CONTOURS AT 85 FT. DEPTH (ppbv) PRIOR TO SVE OPERATION; DASHED WHERE INFERRED
- BUILDING

NOTES:

1. March Trichloroethene concentrations measured between 3/29/04 and 4/1/04, before SVE operation.
2. April Trichloroethene concentrations measured 4/28/04.
3. May 2004 Trichloroethene concentrations measured 5/18/04.
4. June-August Trichloroethene concentrations measured 6/14, 6/17, 7/2, 7/20, and 8/4/04.
5. September Trichloroethene concentrations measured 9/2/04 and 9/23/04.
6. October Trichloroethene concentrations measured 10/7/04, 10/14/04, and 10/22/04.
7. November Trichloroethene concentrations measured 11/17/04, 11/18/04, and 11/22/04.
8. May 2005 Trichloroethene concentrations measured 5/24/05 and 5/25/05.
9. J is a laboratory qualifier (estimated value).
10. Phase I SVE operation April 6 to June 14, 2004; Phase II Sept. 9 to Nov. 8, 2004.

C	8/15/05	CT SVE REPORT	ES	PK
REVISION	DATE	DESCRIPTION	CHKD	APPR
Shaw Environmental, Inc.		Department of the Army Sacramento District, Corps of Engineers Sacramento, California		
DESIGNED:	FIGURE 5-10 TRICHLOROETHENE CONCENTRATIONS DEEP MONITORING PROBES OPERABLE UNIT CARBON TETRACHLORIDE FORMER FORT ORD, CALIFORNIA			
DRAWN:				
CHECKED:				
SUBMITTED:	DATE	SCALE:	SPEC. No.	
		SHEET	FILE No. CTdeep_TCE.mxd	