

Explanation

- Carbon Tet Detected
- Carbon Tetrachloride Not Detected
- Carbon Tetrachloride Concentration Contour in ug/L; Dashed where inferred
- Above MCL
- Groundwater elevation contour (in feet above or below mean sea level, contour interval 10 feet)
- Carbon Tetrachloride Concentration Contour in ug/L; Dashed where inferred
- Suspected Vertical Conduct
- Facilities
- Roads
- Fort Ord Base Boundary
- WELL ID
- MW-OU2-69-180
0.64 A ug/l
- CONCENTRATION IN ug/L WITH MACTEC QUALIFIER

- (1) CONTOURS ARE BASED ON ONE INTERPRETATION OF THE DATA THAT WERE AVAILABLE AT THE TIME THIS REPORT WAS PREPARED; OTHER INTERPRETATIONS MAY BE POSSIBLE.
- (2) CONTOURS BASED ON HIGHEST VALUE OBTAINED FROM MULTIPLE BAGS WHERE APPLICABLE.
- (3) SAMPLE RESULTS FLAGGED WITH AN ASTERISK (*) WERE NOT USED FOR CONTOURING.

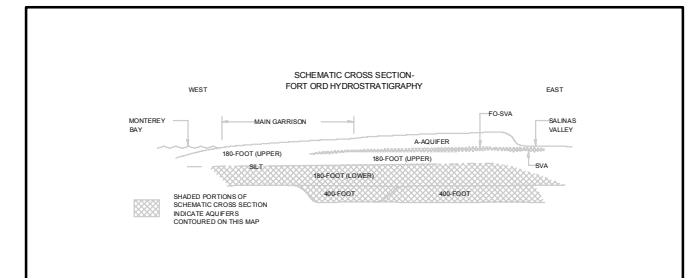

Fort Ord GIS - Plate_17A_CT-TCE_L180_400ft.mxd - 10/25/2005

DESIGNED:	PROJECT NO:	4087030006 010706
DRAWN: FPC	SCALE:	1" = 1500'
APPROVED: <i>MDT</i>	CHECKED:	
DATE:	DATE:	9/2004

MACTEC Engineering and Consulting
 5341 Old Redwood Blvd, Suite 300
 Petaluma, California 94952
 Phone: (707) 793-3800

OU CTP RI/FS
 Former Fort Ord, California

Lower 180-Foot/400-Foot Aquifers
 Carbon Tetrachloride Plume
 September 2004

PLATE:
17A

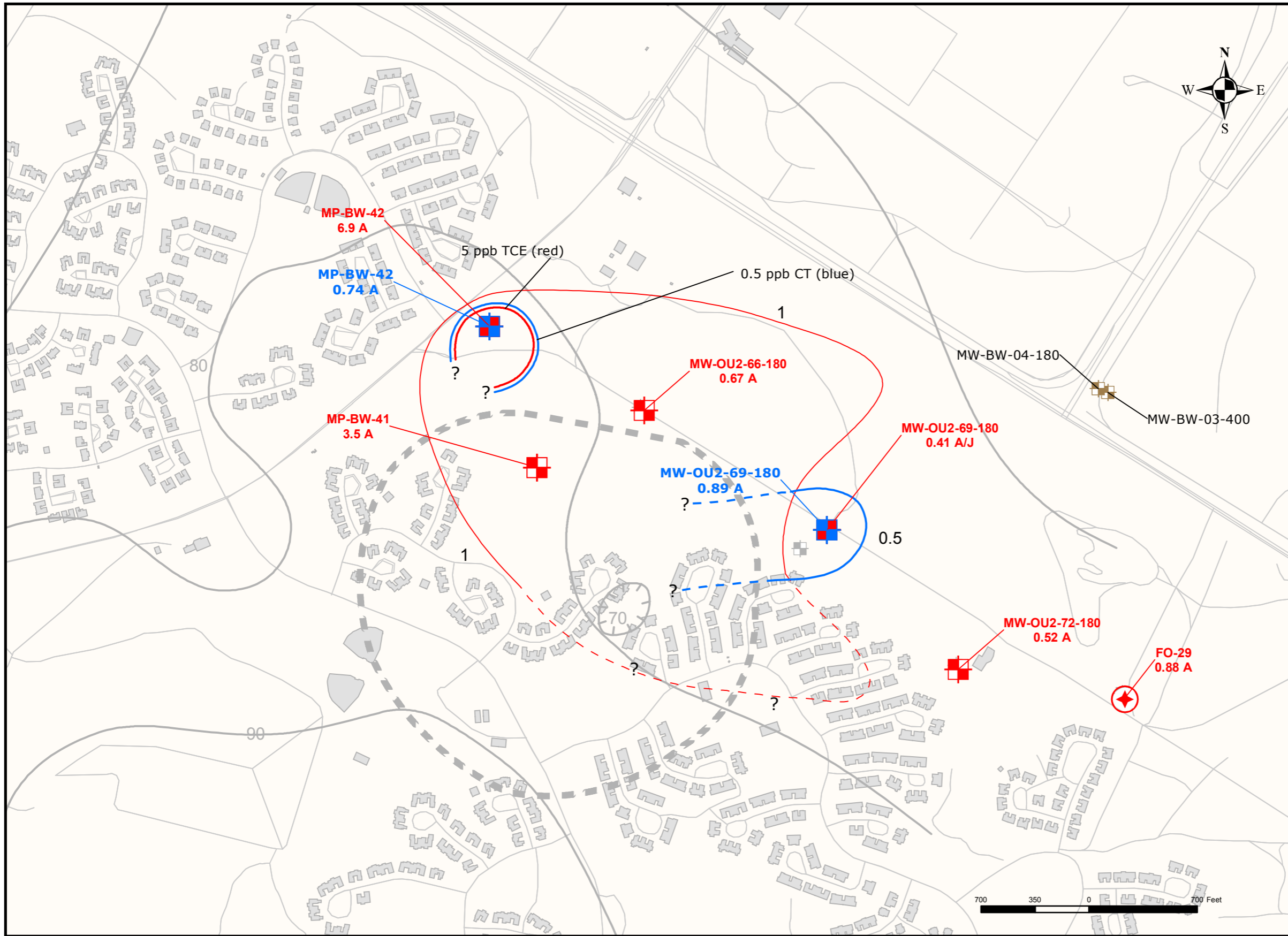

Explanation

TCE Detections	Carbon Tet Detections	Carbon Tet & TCE Detections
Monitoring Well	Monitoring Well	Monitoring Well
Active Supply Well		

TCE and Carbon Tetrachloride Not Detected

Carbon Tetrachloride Concentration Contour in ug/L;
Dashed where inferred

Above MCL

TCE Concentration Contour in ug/L; Dashed where inferred

Above ACL

Below ACL

Groundwater elevation contour (in feet above or below mean sea level, contour interval 10 feet)

Approximate area of vertical communication between the Upper and Lower 180-Foot Aquifers

Facilities

Roads

Fort Ord Base Boundary

WELL ID

MW-OU2-69-180
0.64 A ug/l

CONCENTRATION IN ug/L WITH MACTEC QUALIFIER

- (1) CONTOURS ARE BASED ON ONE INTERPRETATION OF THE DATA THAT WERE AVAILABLE AT THE TIME THIS REPORT WAS PREPARED; OTHER INTERPRETATIONS MAY BE POSSIBLE.
- (2) CONTOURS BASED ON HIGHEST VALUE OBTAINED FROM MULTIPLE BAGS WHERE APPLICABLE.
- (3) SAMPLE RESULTS FLAGGED WITH AN ASTERISK (*) WERE NOT USED FOR CONTOURING.
- (4) CARBON TETRACHLORIDE PLUME CONTINUES FROM UPPER 180-FOOT AQUIFER.

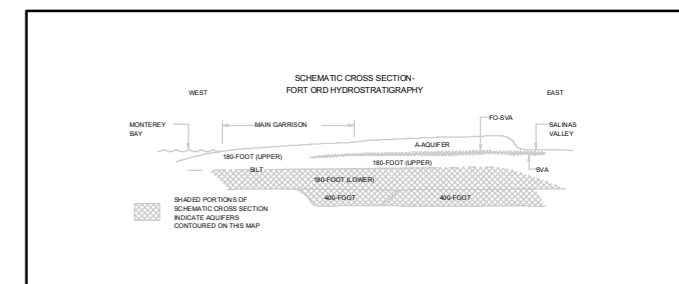

Fort Ord GIS - Plate_17B_C1-TCE_L180_400ft.mxd - 10/25/2005

DESIGNED:	PROJECT NO:	4087030006 010706
DRAWN: FPC	SCALE:	1" = 1000'
APPROVED: <i>MDT</i>	CHECKED:	
DATE:	DATE:	9/2004



MACTEC Engineering and Consulting
5341 Old Redwood Blvd, Suite 300
Petaluma, California 94952
Phone: (707) 793-3800

OU CTP RI/FS
Former Fort Ord, California

Lower 180-Foot/400-Foot Aquifers
Carbon Tetrachloride/TCE Plume
September 2004

PLATE:
17B