

EXPLANATION

- S4.1.3 TRACK 0 PARCEL WITH PARCEL NUMBER
- OE-22 OE SITE BOUNDARY AND SITE NAME
- MACHINE GUN SQUARE

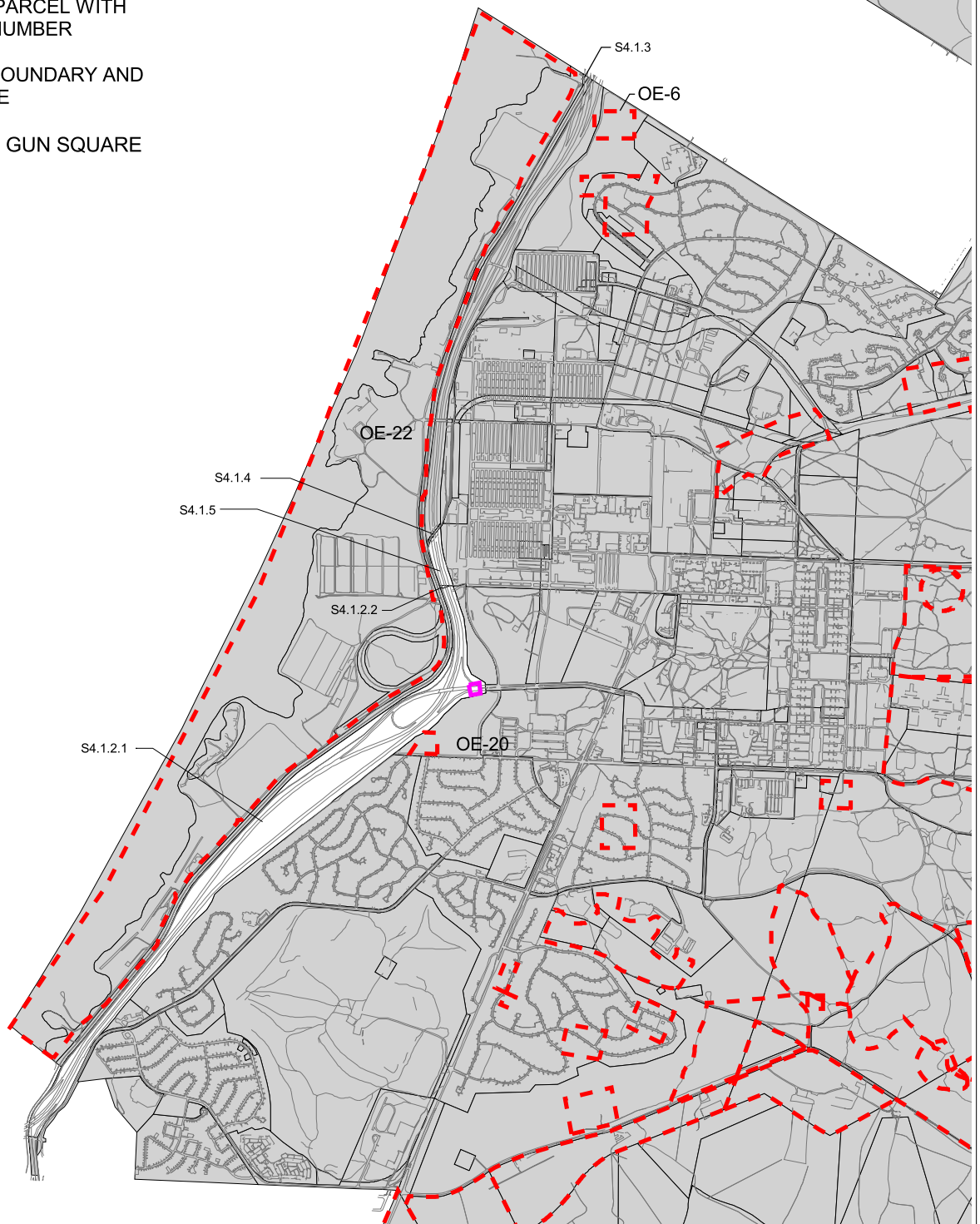

3000 0 3000 Feet

Note: This plate shows the Track 0 parcels for the parcel group described in the plate title. Plate 2 shows all Track 0 parcels identified in the ROD.

track0rod.apr - 7/25/00 - layout 7-3



**Harding Lawson Associates**  
Engineering and Environmental Services

**Highway 1 Parcels**  
Track 0 Record of Decision  
No Further Action Regarding  
Ordnance-Related Investigation  
Former Fort Ord, Monterey, California

PLATE  
**3**

DRAWN TJH  
JOB NUMBER 46310 001751

APPROVED

DATE 7/00

REVISED DATE

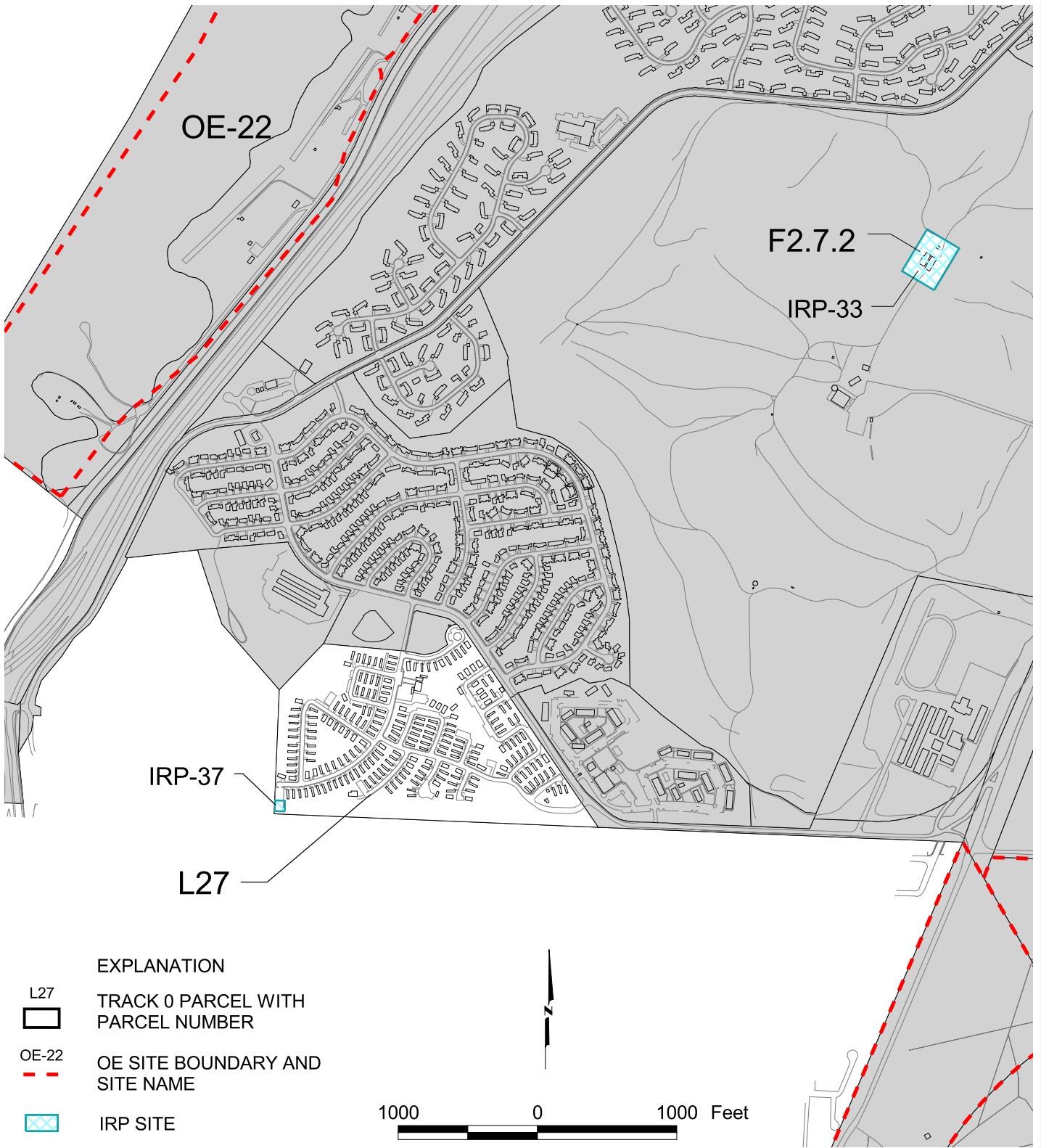

Note: This plate shows the Track 0 parcels for the parcel group described in the plate title. Plate 2 shows all Track 0 parcels identified in the ROD.



**Harding Lawson Associates**  
Engineering and Environmental Services

**Brostrom Park and Golf Course Parcels**  
Track 0 Record of Decision  
No Further Action Regarding  
Ordinance-Related Investigation  
Former Fort Ord, Monterey, California

PLATE

**4**

DRAWN: TJH  
JOB NUMBER: 46310 001751

APPROVED

DATE: 7/00

REVISED DATE

track0rod.apr - layout 2-4 - 7/25/00

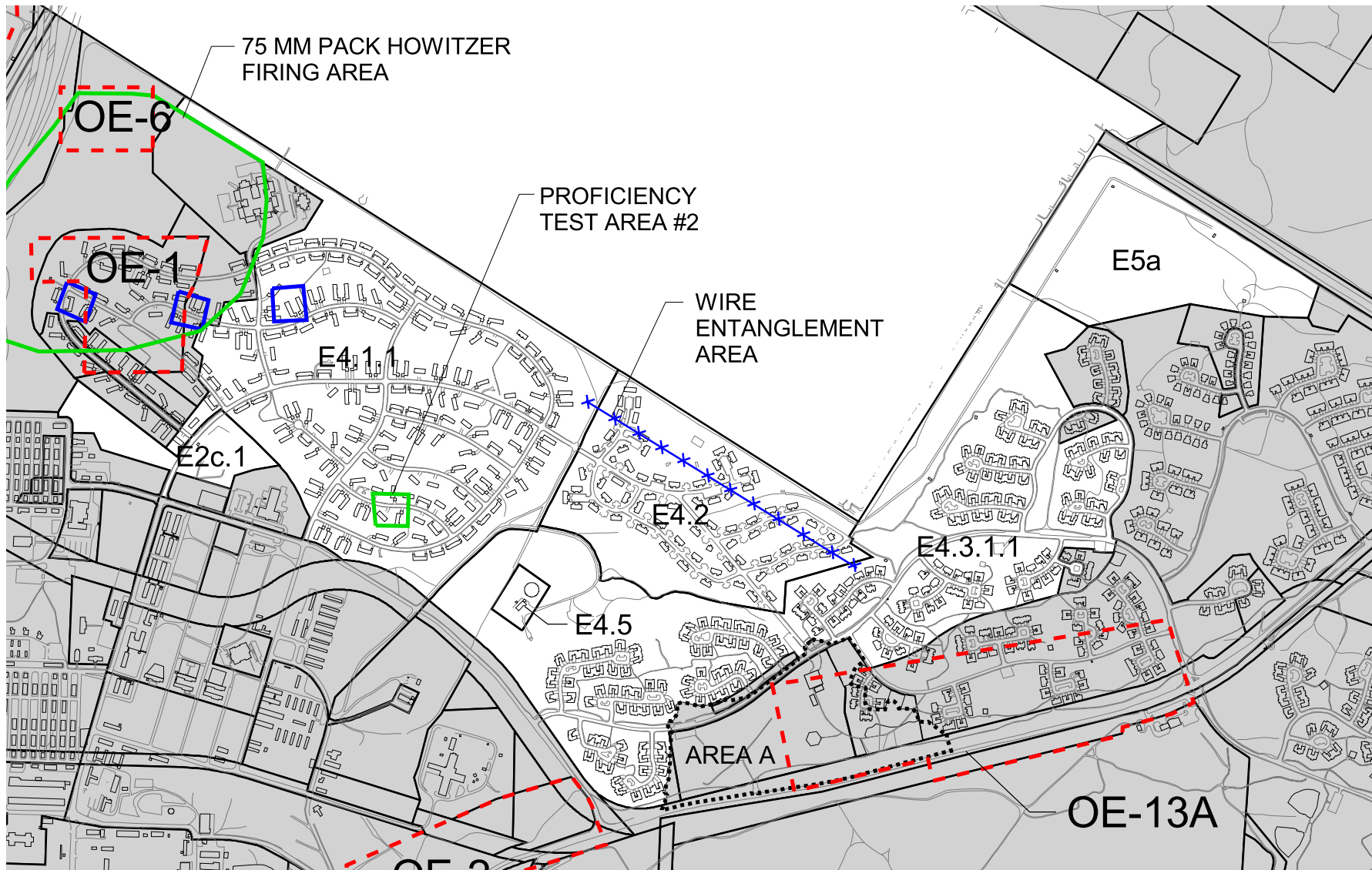

**EXPLANATION**

- L5.6.1 TRACK 0 PARCEL WITH PARCEL NUMBER  
 TRACK 0 PARCEL WITH PARCEL NUMBER
- OE-13A OE SITE BOUNDARY AND SITE NAME  
 OE SITE BOUNDARY AND SITE NAME
- ..... EXTENT OF EXCAVATED AND GRADED LANDFILL AREA (AREA A)  
 EXTENT OF EXCAVATED AND GRADED LANDFILL AREA (AREA A)
- MORTAR SQUARE

Note: This plate shows the Track 0 parcels for the parcel group described in the plate title. Plate 2 shows all Track 0 parcels identified in the ROD.

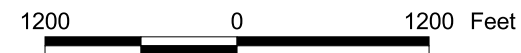

**Harding Lawson Associates**

Engineering and Environmental Services

DRAWN TJH      JOB NUMBER 46310 001751

**Patton/Abrams Park Housing Area Parcels**

Track 0 Record of Decision  
 No Further Action Regarding  
 Ordnance-Related Investigation  
 Former Fort Ord, Monterey, California

APPROVED      DATE 7/00

PLATE

**5**

REVISED DATE 5/02